

PLAT OF SURVEY

Lot 12

Lot 11

Lot 13

Block

Lot 14

0.2 Acres ±  
Total

Concrete

Patio

Garage

Dwelling

Blacktop

Driveway

Wright Street  
(VACATED)

66' Wide

Centralia Street

Lot 14 and the South 4 feet of Lot 11 of Block 7 of Elderkins Addition Subdivision, located in part of the Northwest 1/4 of Section 6, Town 2 North, Range 17 East, City of Elkhorn, Walworth County, Wisconsin.

Owner: Brenda Deakins  
308 East Centralia Street  
Elkhorn, Wisconsin 53121

Ordered by: Sue Miller  
Broker/Owner  
Whispering Oaks Realty  
Post Office Box 16  
Elkhorn, Wisconsin 53121-0016

NOTES

- 1) The North Line of Centralia Street was assumed to bear S 85°30'00" W as shown on the Original Plat of Elderkins Addition Subdivision.
- 2) The Original Plat of Elderkins Addition by H.M. Eastman, Dated February 12, 1856 was replatted by H.H. Tubbs, City Engineer, Dated July 1930, the replat dimensions were used to survey this parcel.

Legend

- FOUND IRON PIPE
- FOUND IRON ROD
- FOUND BRASS CAPPED MONUMENT
- FOUND CONCRETE MONUMENT
- CHISEL CUT IN CONCRETE
- SET IRON ROD, 24" LONG, WEIGHING 1.5 LBS. LINEAL FT., 3/4" DIA.
- SET IRON ROD, 36" LONG, WEIGHING 4.5 LBS. LINEAL FT., 1-1/16" DIA.
- RECORDED AS DIMENSION
- EXISTING FENCE

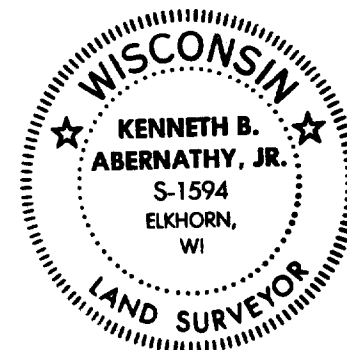

SCALE: 1"= 10 FEET

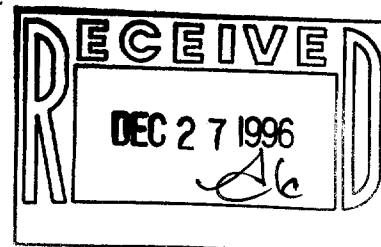

I hereby certify that the above described property has been surveyed by me or under my direction and that the above map is a true representation thereof and shows the size and location of the property, its exterior boundaries, the location of all visible structures, and dimensions of all principal buildings thereon, boundary fences, apparent easements, roadways and visible encroachments, if any. This survey is made for the use of the present owners of the property, and also those who purchase, mortgage, or guarantee the title thereto within one year from date hereof.

Kenneth B. Abernathy, Jr.  
KENNETH B. ABERNATHY, JR.  
WISCONSIN REGISTERED LAND SURVEYOR,  
S-1594

Date: August 7, 1996 Job No. 1996.712